



CA14

TRIMMER POTENTIOMETER

CA14 14mm Carbon Potentiometer



特点

- 长寿命, 低成本。
- 优良的防尘结构 没有任何开口部分。
- 力矩小。
- 阻值线性多样化。
- 旋转50%处有定位或整个旋转行程带定位。
- 品种规格多 适用性强

FEATURES

- Carbon resistive element.
- Dust proof enclosure.
- Polyester substrate.
- Also upon request:
 - ◇ Wiper positioned at 50% or fully clockwise.
 - ◇ Supplied in magazines for automatic insertion.
 - ◇ Long life model CA-14...E(10000 cycles)
 - ◇ Housing available in self extinguishable plastic (UL94V0)

机械性能 MECHANICAL SPECIFICATIONS

- 机械 —Mechanical
 - 旋转角度 rotation angle: $265^\circ \pm 5^\circ$
- 电气 —Electrical
 - 旋转角度 rotation angle: $245^\circ \pm 20^\circ$
- 旋转力矩 —Torque: $< 2.5\text{Ncm}$.
- 止档强度 —Stop torque: 10Ncm

电器性能 ELECTRICAL SPECIFICATIONS

- 阻值范围 Range of values: $100\Omega \leq R_n \leq 5\text{M}$
- 阻值误差 —Tolerance: $100\Omega \leq R_n \leq 1\text{M}$ --- $\pm 20\%$
 $1\text{M} \leq R_n \leq 5\text{M}$ --- $\pm 30\%$
- 耐电压 —Max. Voltage: $250\text{VDC}(\text{lin}), 200\text{VDC}(\text{no lin})$
- 额定功率 —Nominal Power 40°C $0.25\text{W}(\text{lin})$ $0.13\text{W}(\text{no lin})$
- 线性 —Taper: Lin(A); Log(B); Antilog(C)
- 残留电阻 —Residual resistance: Lin, Log, Antilog $\leq 5 \times 10^{-3} R_n$
- 平滑性 —Equivalent Noise Resistance: $\leq 3\% R_n$
- 环境温度 —Operating Temperature: $-25^\circ\text{C} \sim +70^\circ\text{C}$

型号命名 HOW TO ORDER

STANDARD				OPTIONAL EXTRAS			
CA-14	L	V	102	A	2020		
序列号 Series	孔的形式 Rotors	阻值 Value	电阻规律 Taper	寿命 Life	误差 Tolerance	Cut track	Wiper position
CA-14	L M N Z D E T	102=100Ω 505=5M	A=Lin. (直线) B=Log. (指数) C=Alg. (对数)	E=Extended life	2020=20% 3030=30%	PCI=Initial PCF=Final	PM50% PF=Final position
	安装方式 Mounting Method		柄 / 孔的颜色 Shaft/rotor colour				
	H0, HC0 H2.5, H4 H5, HA5 HL5, V12.5 VA12.5, VL12.5 VR12.5, VD11 VD7.5, V15 V17.5, V15...CFF HSMD VSMD		NE=Black BA=White IN=Neutral TA=Transparent RO=Red VE=Green AM=Yellow AZ=Blue GS=Grey MR=Brown				

TRIMMER POTENTIOMETER



CA14

ROTORS (孔的形式)

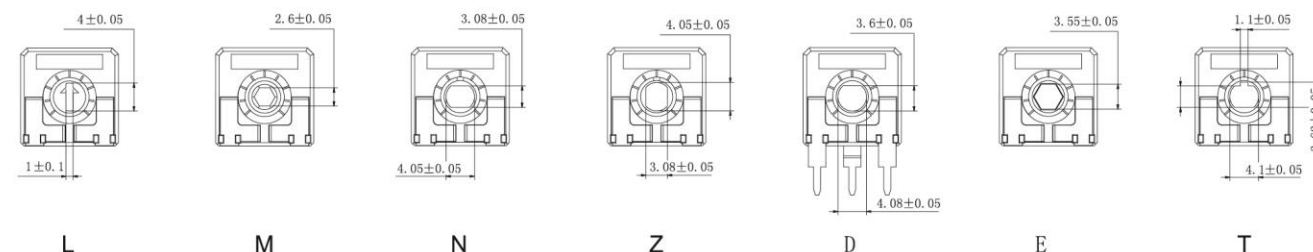

MOUNTING METHODS (安装方式)

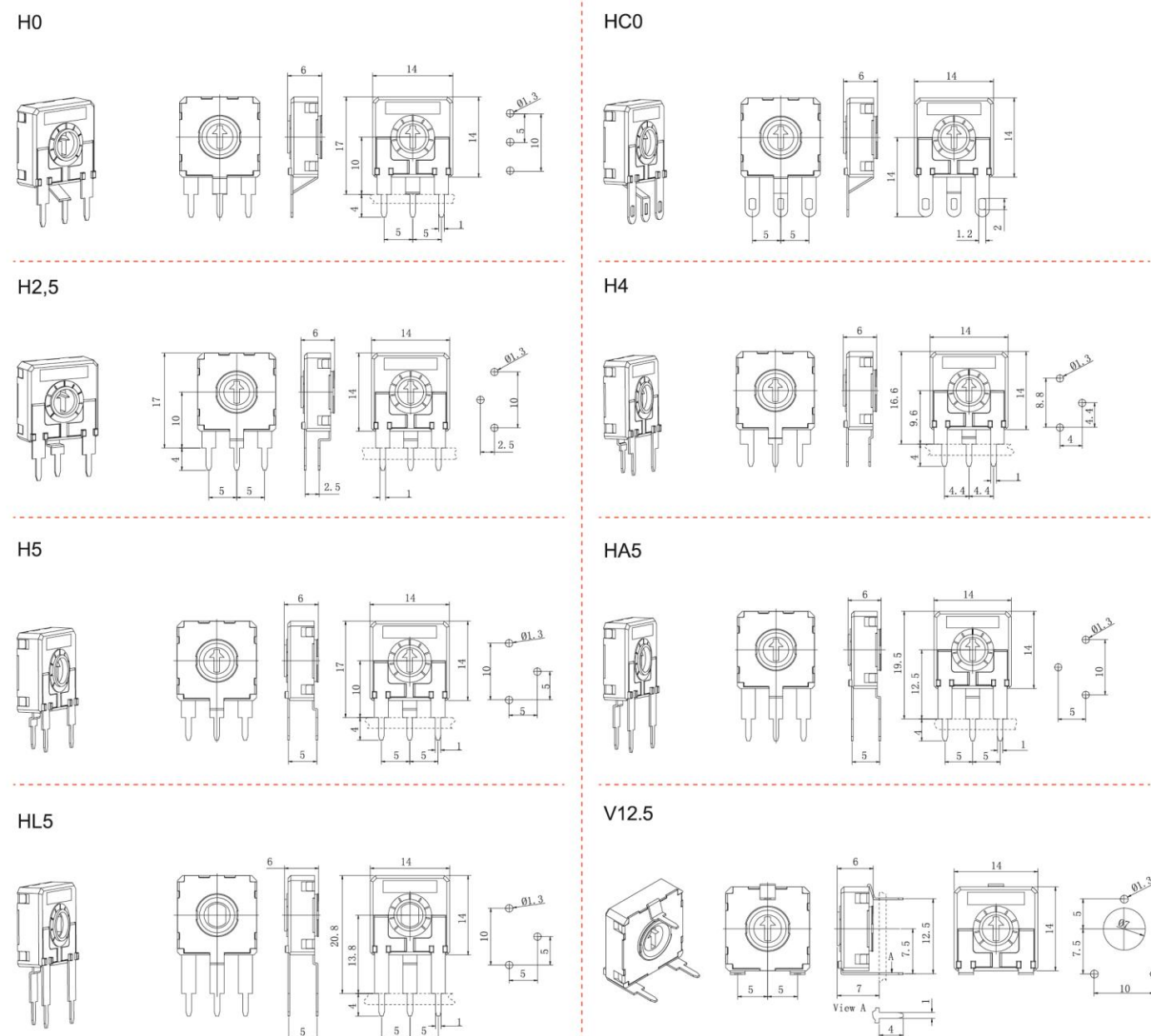



CA14

TRIMMER POTENTIOMETER

VA12.5

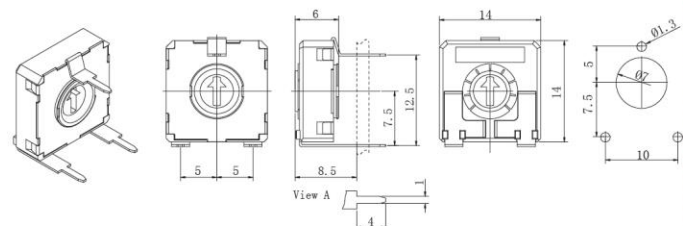

VL12.5

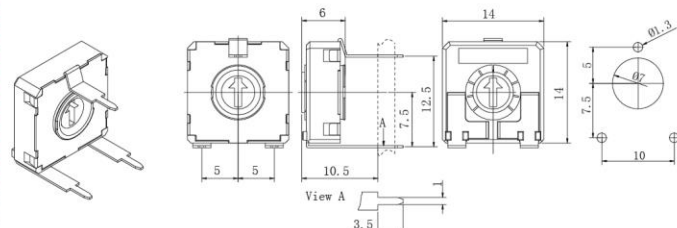

VR12.5

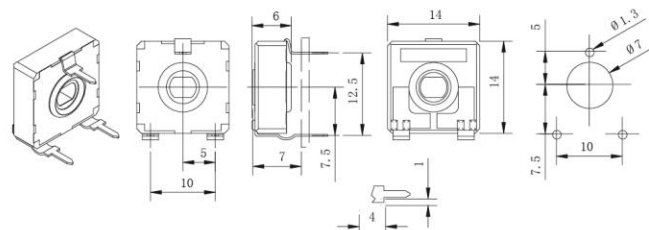

V15

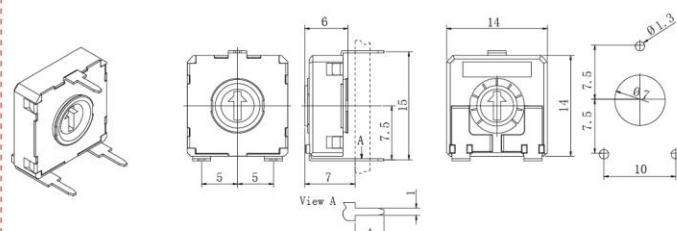

V15...CFF

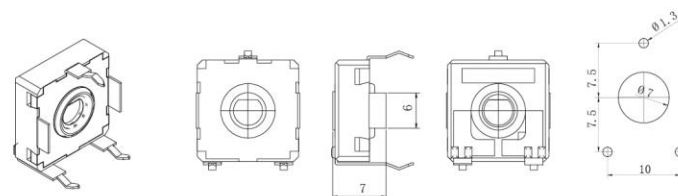

V17.5

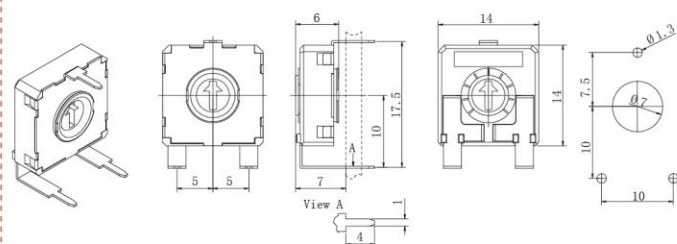

VD7.5

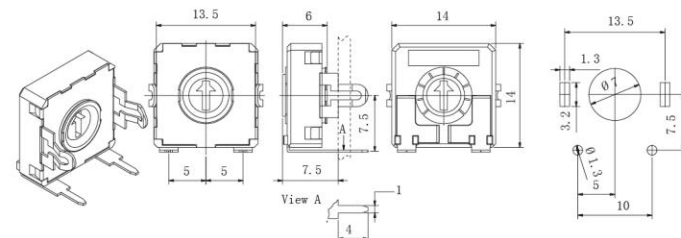

VD11

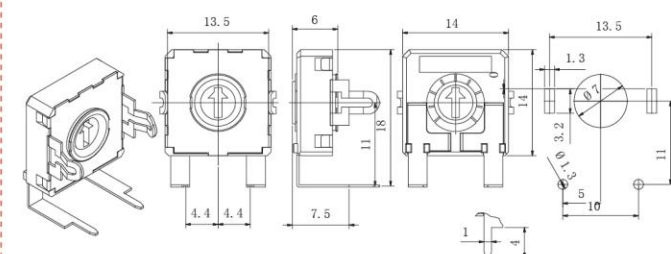

HSMD

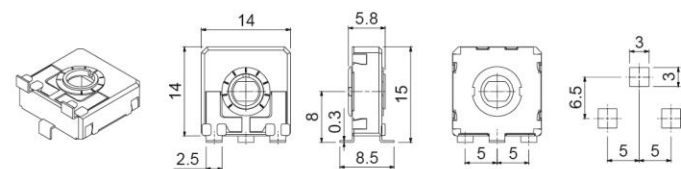

VSMD

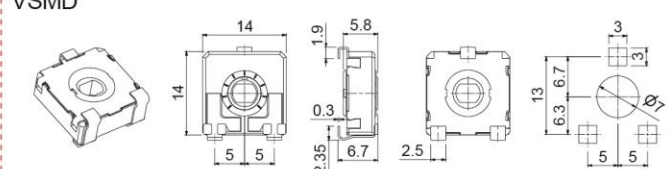

TRIMMER POTENTIOMETER



CA14

Terminals (焊脚种类)

We can provide crimped terminals (with "snap in"), to better hold the component to the board prior to soldering.

我们可以提供打弯式的焊脚，以便在焊接前能够更好的安装在PCB板上

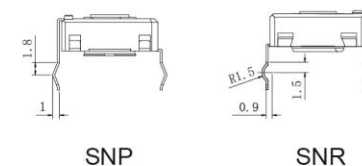

Adjustment possibilities (手柄安装方式)

Potentiometers can be adjusted through either the front side (WT) or the collector side (WTI):

电位器手柄可以插入电位器正面或者背面调节

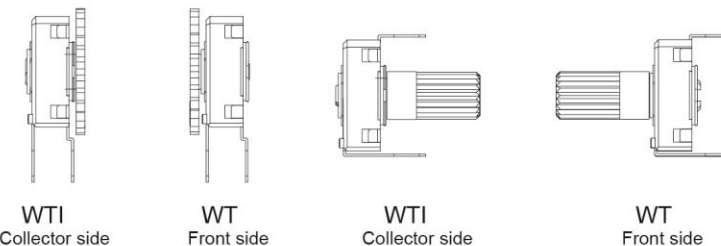

Potentiometers with cut track 电位器带开关功能

Recommended for lighting regulation. (推荐使用领域为灯光调节)

With cut at the beginning of the track CCW:off-on. (开关在电阻的起始位置, CCW: 关-开)

With cut at the end of track-CW:on-off. Others positions available on request.

(开关在电阻的末端位置, CW, 开-关。其他可根据要求定制)



CCW: Off-On
CCW: 关-开

CW: On-Off
CW: 开-关

Potentiometers with detents (电位器带定位功能)

Detent feature(DT) is specially for control application. Detents can be 2,6,22,27 and up to 38.

带定位的产品可适用于控制设备, 定位次数可以为2, 6, 22, 27最高可达38次定位。

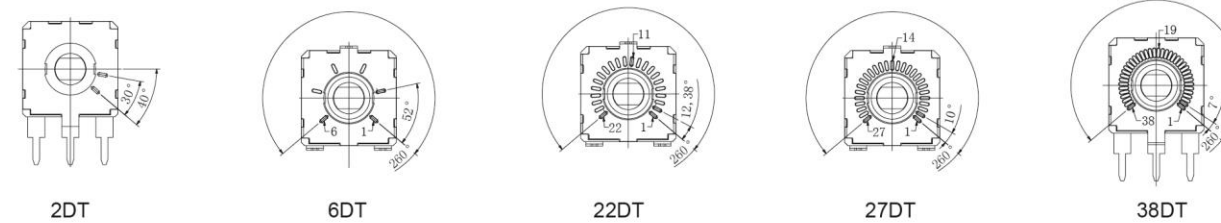

TAPERS

Standard

A = Linear
B = Log.
C = Alog.

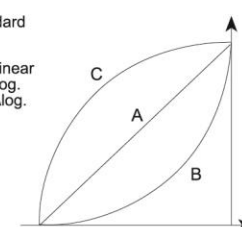

Special taper example

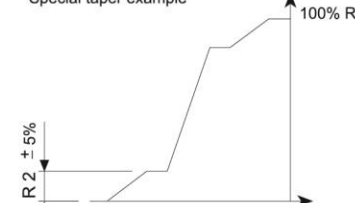

POWER RATING CURVE

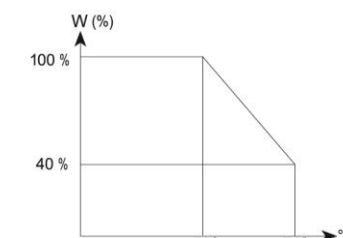

NOTE = Please note relative terminals positions when ordering non linear tapers.



CA14

TRIMMER POTENTIOMETER

TRIMMER POTENTIOMETER



TESTS

ELECTRICAL LIFE	1.000h @ 50°C;0.15W	± 5%
MECHANICAL LIFE(CYCLES)	500 @ 10CPM...15CPM	± 3% (Rn<1M Ω)
TEMPERATURE COEFFICIENT	-25°C; +70°C	± 300ppm(Rn<100K)
THERMAL CYCLING	16h.@ 85°C;2h.@ -25°C	± 2.5%
DAMP HEAT	500h.@ 40°C @95%HR	± 5%
VIBRATION (for each plane X,Y,Z)	2h.@10Hz... 55Hz.	± 2%

NOTE:Out of range values may not comply with these results.

SHAFT TYPE 手柄种类

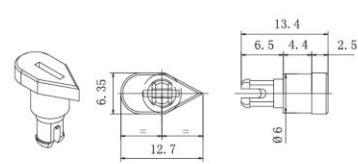

14042

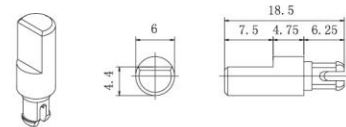

14056

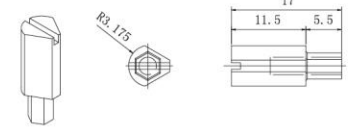

14065

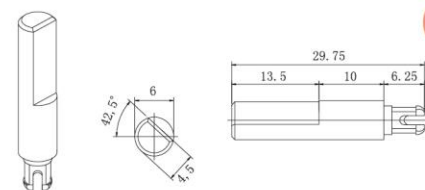

14066

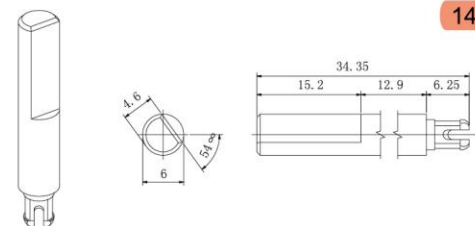

14067

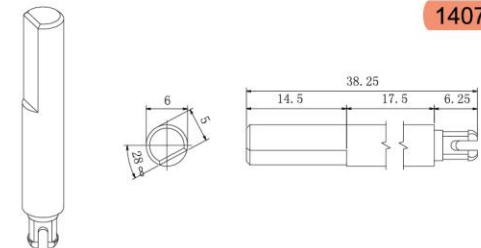

14072

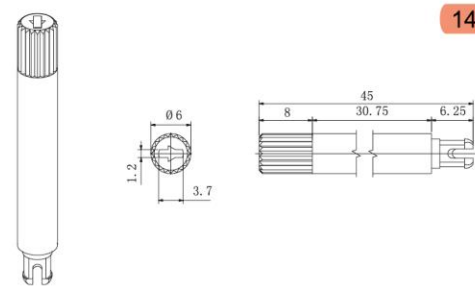

14073

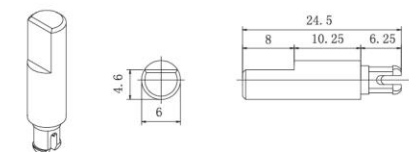

14081

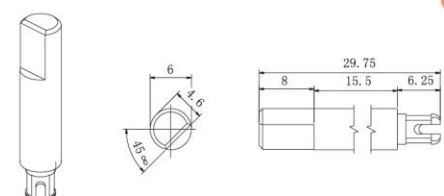

14084

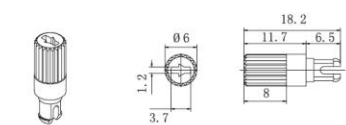

14117

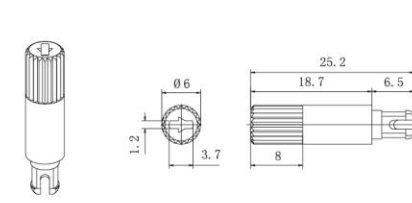

14187

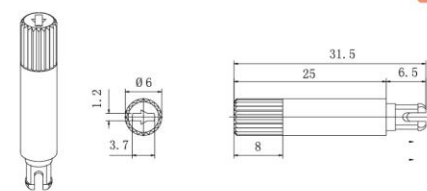

14250

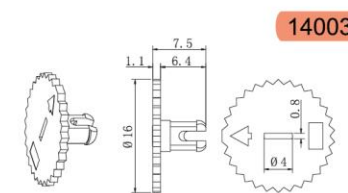

14003

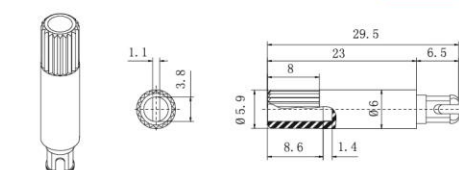

14008

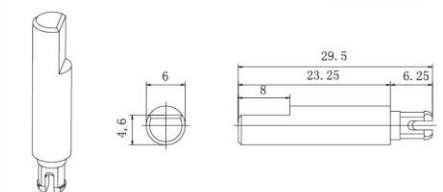

14015

PCB board Resistor printed (线路板电阻体印刷)

可提供来料加工, 根据客户的要求定制各种形状的电阻体
Provides processing, according to customer requirements of a variety of customized resistance body shape

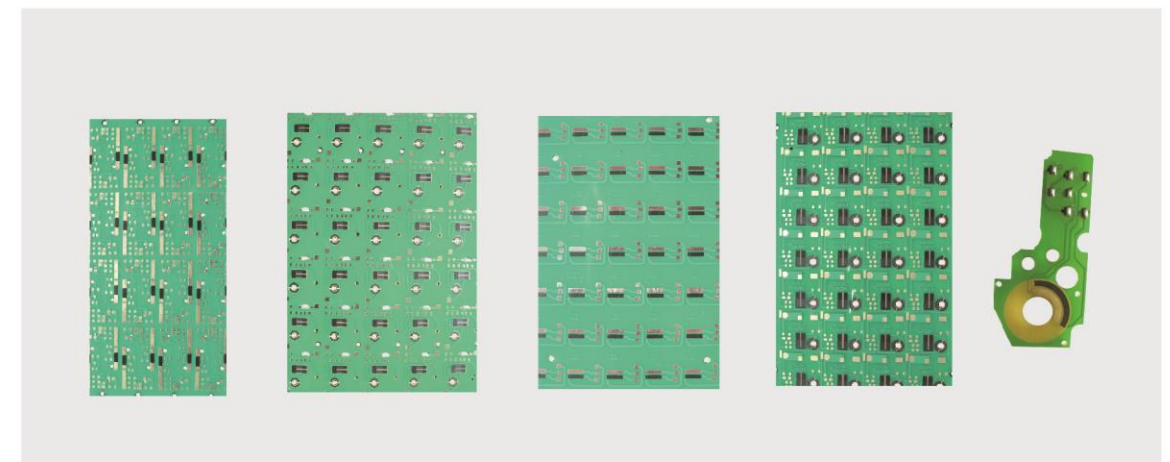

Automatic production line 全自动生产线



Laser marking machine 全自动激光打标机

