

序号/RevNo.	名称/Title	文件编号/File No.
1	114单排塑料件	QJ/XYT-11124
2	114端子图(直)	QJ/XYT-11128

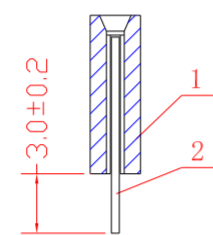
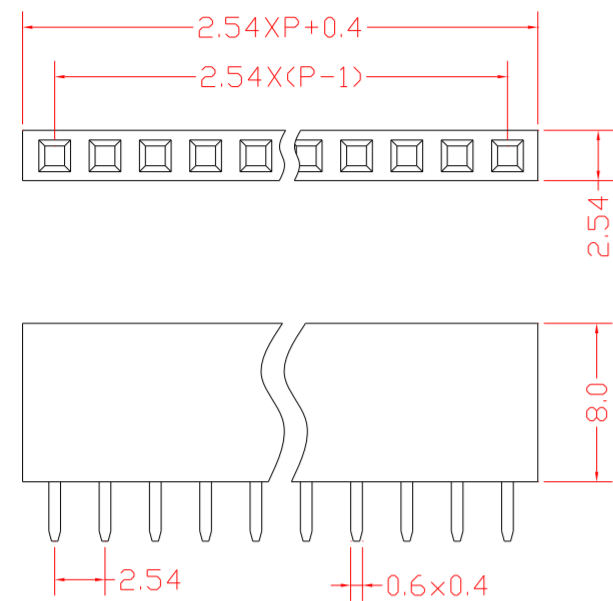

Specifications:
 Contact Resistance: 30mΩ max.at DC 100 mA
 Insulator Resistance: 1000MΩ min.at DC 500V
 Current Rating: 1AMP

Dielectric Withstanding
 Voltage: AC 500V For 1 minute
 Operating Temperature:-55°C--+105°C
 Contact: Brass
 Housing: PBT &30% Glass Fiber(UL 94V-0)

- 要求:
1. 塑料件无裂痕。
 2. 整排端子成一直线，相邻端子之间相互平行。

设计/Designed by	绘图/Drawing by	审核/Checked by	批准/Approved by	未注公差 General Tolerance
				x. ±0.2 x.' ±2' .x ±0.1 .x' ±1' .xx ±0.05 .xx' ±0.5 .xxx ±0.01
		图名/Title	文件编号/File No.	
		114-A单排直针 产品图	QJ/XYT-12034	
		页序/Sheet		
		备注/Remark		单位/Units: mm

序号/RevNo.	更改记录/Revision note	签名/Signature	日期/Date

序号/RevNo.	名称/Title	文件编号/File No.
1	114双排塑料件	QJ/XYT-11125
2	114端子图(直)	QJ/XYT-11128

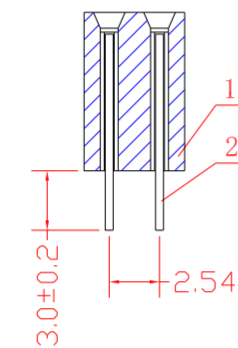
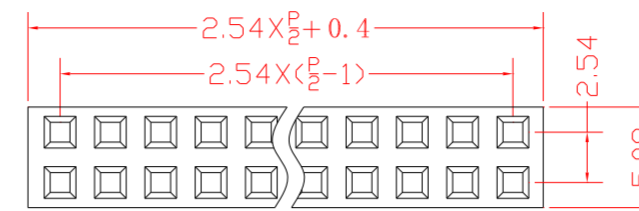

Specifications:
 Contact Resistance: 30mΩ max.at DC 100 mA
 Insulator Resistance: 1000MΩ min.at DC 500V
 Current Rating: 1AMP

Dielectric Withstanding
 Voltage: AC 500V For 1 minute
 Operating Temperature:-55°C--+105°C
 Contact: Brass
 Housing: PBT &30% Glass Fiber(UL 94V-0)

- 要求:
1. 塑料件无裂痕。
 2. 整排针成一直线，相邻针之间相互平行。

设计/Designed by	绘图/Drawing by	审核/Checked by	批准/Approved by	未注公差 General Tolerance
				x. ±0.2 x.' ±2' .x ±0.1 .x' ±1' .xx ±0.05 .xx' ±0.5 .xxx ±0.01
		图名/Title	文件编号/File No.	
		114-A双排直针 产品图	QJ/XYT-12035	
		页序/Sheet		
		备注/Remark		单位/Units: mm

序号/RevNo.	更改记录/Revision note	签名/Signature	日期/Date

序号/RevNo.	名称/Title	文件编号/File No.
1	114单排塑料件	QJ/XYT-11124
2	114端子(短弯)	QJ/XYT-11126

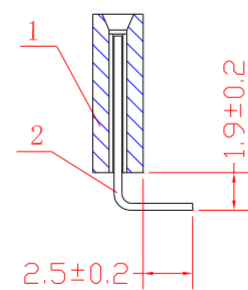
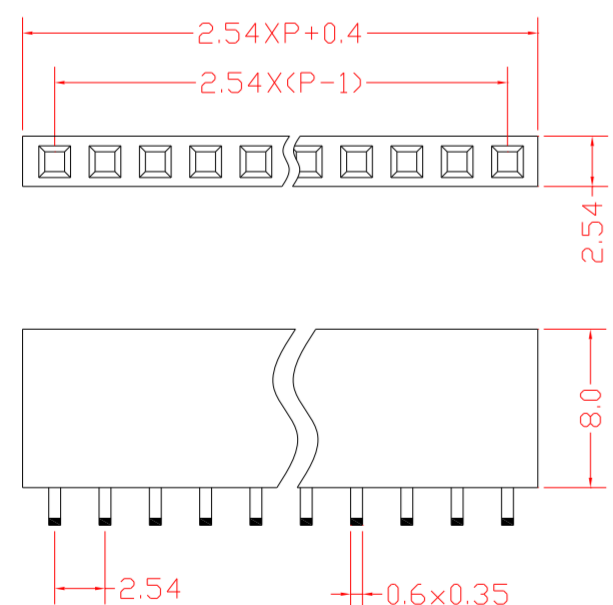

Specifications:
 Contact Resistance: 30mΩ max.at DC 100 mA
 Insulator Resistance: 1000MΩ min.at DC 500V
 Current Rating: 1AMP

Dielectric Withstanding
 Voltage: AC 500V For 1 minute
 Operating Temperature:-55°C--+105°C
 Contact: Brass
 Housing: PBT &30% Glass Fiber(UL 94V-0)

- 要求:
1. 塑料件无裂痕。
 2. 整排端子成一直线，相邻端子之间相互平行。

设计/Designed by	绘图/Drawing by	审核/Checked by	批准/Approved by	未注公差 General Tolerance
				x. ±0.2 x.' ±2' .x ±0.1 .x' ±1' .xx ±0.05 .xx' ±0.5 .xxx ±0.01
		图名/Title	文件编号/File No.	
		114-A单排弯针 产品图	QJ/XYT-12036	
		页序/Sheet		
		备注/Remark		单位/Units: mm

序号/RevNo.	更改记录/Revision note	签名/Signature	日期/Date

序号/RevNo.	名称/Title	文件编号/File No.
1	114双排塑料件	QJ/XYT-11125
2	114端子(短弯)	QJ/XYT-11126
3	114端子(长弯)	QJ/XYT-11127

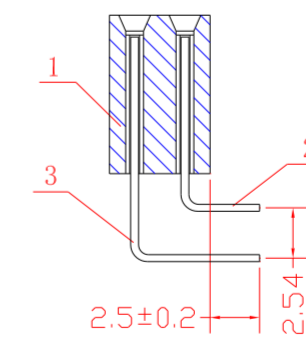
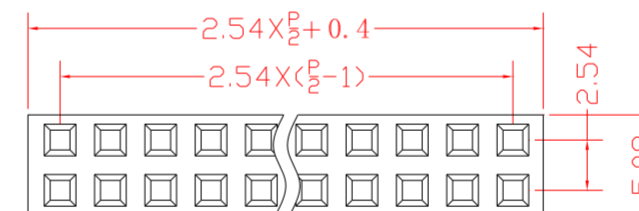

Specifications:
 Contact Resistance: 30mΩ max.at DC 100 mA
 Insulator Resistance: 1000MΩ min.at DC 500V
 Current Rating: 1AMP

Dielectric Withstanding
 Voltage: AC 500V For 1 minute
 Operating Temperature:-55°C--+105°C
 Contact: Brass
 Housing: PBT &30% Glass Fiber(UL 94V-0)

- 要求:
1. 塑料件无裂痕。
 2. 整排针成一直线，相邻针之间相互平行。

设计/Designed by	绘图/Drawing by	审核/Checked by	批准/Approved by	未注公差 General Tolerance
				x. ±0.2 x.' ±2' .x ±0.1 .x' ±1' .xx ±0.05 .xx' ±0.5 .xxx ±0.01
		图名/Title	文件编号/File No.	
		114-A双排弯针 产品图	QJ/XYT-12037	
		页序/Sheet		
		备注/Remark		单位/Units: mm

序号/RevNo.	更改记录/Revision note	签名/Signature	日期/Date