

SERIES SC792 SINGLE POLE ROCKER SWITCHES

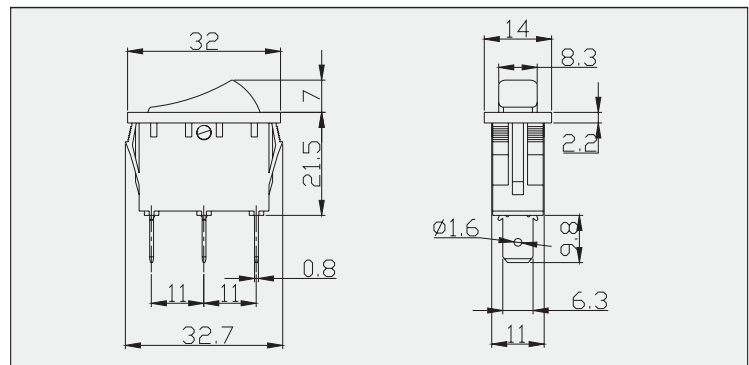

SC792-6MAW-00



APPLIANCE CUT-OUT

single pole X=panel thickness

	X	Y	Z
	0.75~1.25	30.2-0.1	11.2+0.1
	1.25~2	30.4-0.1	11.2+0.1
	2~3	30.6-0.1	11.2+0.1

◆ PRODUCT ADVANTAGE

- Various rocker for your choice
- Excellent actuation characteristic
- Excellent SWPB spring support enough contact force and ensure mechanical life
- Accessional waterproof hat for your choice
- Usually use in oven、coffee maker、stirrer、power strip,ets

◆ TECHNICAL SPECIFICATIONS

Electrical rating	15A 125V/250VAC 15(3)A 250VAC 1E4 T125/55
Electrical life	1E4
Mechanical life	5E4
Contact resistance	≤20m Ω
Insulation resistance	> 100M Ω
High voltage resistance	1500 VAC
Resistance to tracking	PTI 175
Contact gap DT with centre-OFF	>3mm
Protection type	IP20
Ambient temperature	0°C...+125°C
Flammability	UL94V-0
Heat and fire resistance	850°C
Material of housing and rocker	PA/PC
Material of Contacts	Ag or AgCdO
Material of Terminals	Copper Alloy
Temperature rise at the terminals (According to electrical life endurance)	Max.30K (UL1054) Max.55K (EN61058-1)
Push-on force of terminals	≥96N
Approval marks	
Suitable for appliances of protection class II	

SERIES SC792 SINGLE POLE ROCKER SWITCHES

◆ PART NUMBER

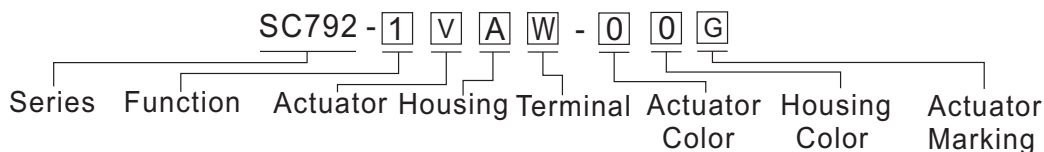

Function(1)		
Function	Circuitry	Code
ON-OFF		1
ON-ON		2
ON-OFF(RESET)		4
ON-OFF with Lamp		6

Housing(3)	
Versions	Code
	A

Terminals(4)		
Terminals	Versions	Code
Quick-connect terminal 6.3X0.8mm		W

Actuator(2)		
Actuator shape	Versions	Code
Arc Button		V
Arc Button with point light		M
Push-On/Push-Off Circle Button		P
Flag Button		F
Push-On/Push-Off Quadrate Button		K

Actuator Marking(5)			
Versions	Code	Versions	Code
	G	ON	R
	P	OFF	
	P		W

Examples of Common Part Numbers and Descriptions

Part Number	Circuitry	Switch Function	Terminal Type	Actuator/Housing Color	Marking
SC792- 1VAW-00G		ON-OFF	Quick-connect terminal 6.3X0.8mm	Black/Black	
SC792- 2PAW-00		ON-ON	Quick-connect terminal 6.3X0.8mm	Black/Black	
SC792- 6MAW-00		ON-OFF with Point Light	Quick-connect terminal 6.3X0.8mm	Black/Black	