

## Dual High-voltage Switching Diode



**SOT-23**

### Features

- Epoxy meets UL-94 V-0 flammability rating and halogen free
- Moisture Sensitivity Level 1
- Fast Switching Speed
- High Conductance
- Part no. with suffix "Q" means AEC-Q101 qualified

### Applications

- For General Purpose Switching Applications

### Mechanical Data

- Case: SOT-23
- Terminals: Tin plated leads, solderable per J-STD-002 and JESD22-B102

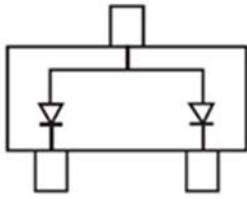

BAV23AQ Marking: KT7

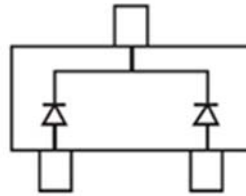

BAV23CQ Marking: KT6

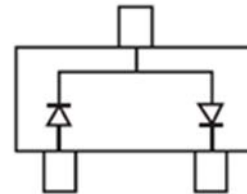

BAV23SQ Marking: KL31

### ■ Maximum Rating, ( $T_a=25^\circ\text{C}$ Unless otherwise specified)

Item	Symbol	Unit	Value
Repetitive peak reverse voltage	$V_{RRM}$	V	250
Forward Continuous Current, Per Leg	$I_F^{[1]}$	mA	225
Non-Repetitive Peak Forward Surge Current@ $t_p=10\text{ms}$ ,	$I_{FSM}$	A	1.7
Power Dissipation	$P_D^{[1]}$	mW	350
Thermal Resistance from Junction to Ambient	$R_{thJA}$	$^\circ\text{C}/\text{W}$	357
Operation Junction Temperature	$T_J$	$^\circ\text{C}$	-55 to +150
Storage Temperature	$T_{STG}$	$^\circ\text{C}$	-55 to +150

[1] Single diode loaded



# BAV23AQ/CQ/SQ

## ■ Electrical Characteristics (T<sub>a</sub>=25°C Unless otherwise specified, Per Leg)

Item	Symbol	Unit	Conditions	Min	Typ	Max
Reverse Voltage	V <sub>BR</sub>	V	I <sub>R</sub> =100uA	250		
Forward Voltage	V <sub>F</sub>	V	I <sub>FM</sub> =100mA, T <sub>J</sub> =25°C			1
			I <sub>FM</sub> =200mA, T <sub>J</sub> =25°C			1.25
Reverse Current	I <sub>R</sub>	uA	V <sub>R</sub> =200V			0.1
Total Capacitance	C <sub>tot</sub>	pF	f=1.0MHz, V <sub>R</sub> =0V			5
Reverse Recovery Time	T <sub>rr</sub>	ns	I <sub>F</sub> =I <sub>R</sub> =30mA, V <sub>R</sub> =6V, R <sub>L</sub> =100Ω, I <sub>rr</sub> =3mA			50

## ■ Ordering Information (Example)

PREFERRED P/N	PACKING CODE	UNIT WEIGHT(g)	MINIMUM PACKAGE(pcs)	INNER BOX QUANTITY(pcs)	OUTER CARTON QUANTITY(pcs)	DELIVERY MODE
BAV23AQ/CQ/SQ	F2	Approximate 0.01	3000	30000	120000	7" reel

## ■ Typical Characteristics (Per Leg)

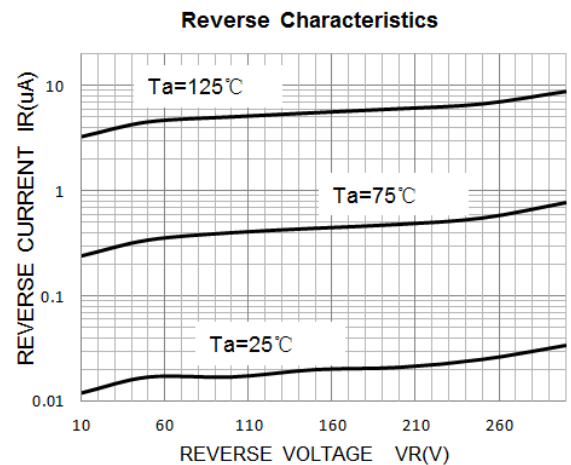
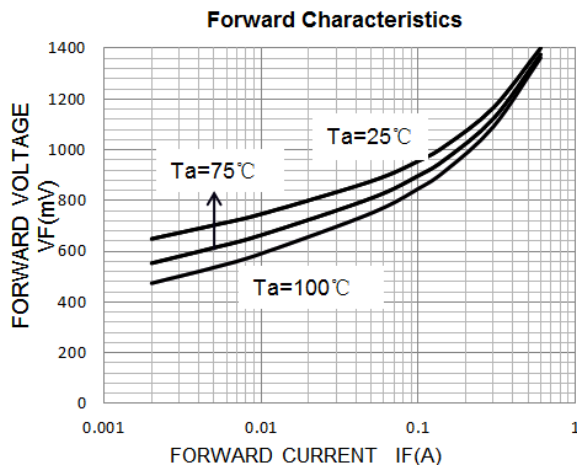
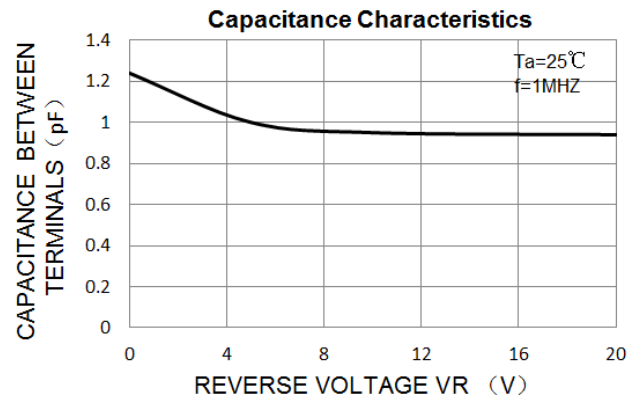
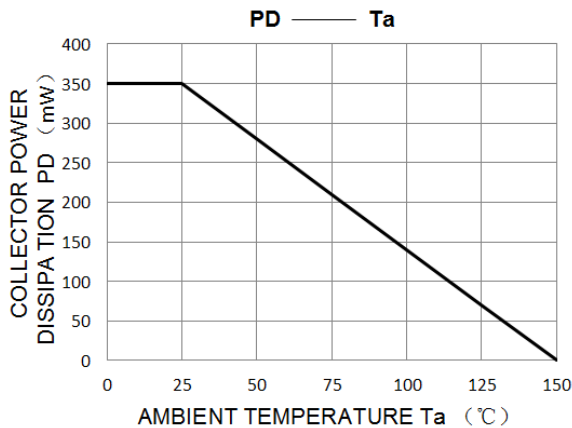



# BAV23AQ/CQ/SQ

## ■SOT-23 Package Outline Dimensions

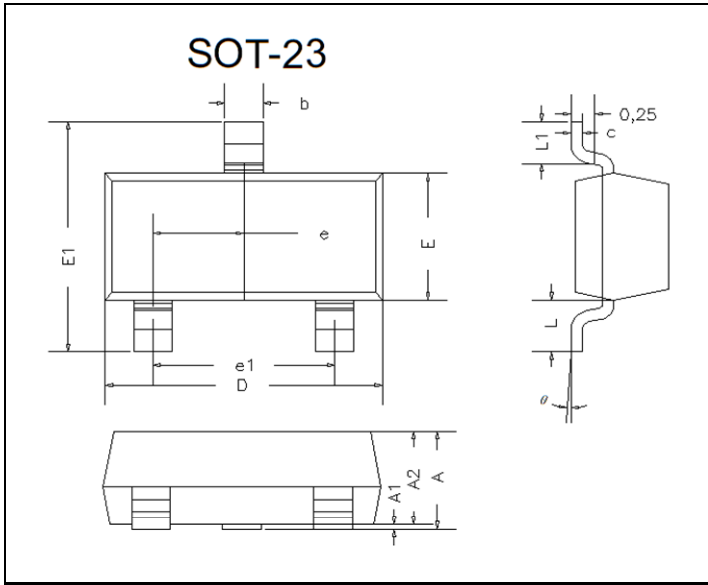

DIM	INCHES		MM		NOTE
	MIN	MAX	MIN	MAX	
A	0.035	0.045	0.90	1.15	
A1	0.000	0.004	0.00	0.10	
A2	0.035	0.041	0.90	1.05	
b	0.012	0.020	0.30	0.50	
c	0.004	0.008	0.10	0.20	
D	0.110	0.118	2.80	3.00	
E	0.047	0.055	1.20	1.40	
E1	0.089	0.100	2.25	2.55	
e	0.370TYP		0.95TYP		
e1	0.071	0.079	1.80	2.00	
L	0.220REF		0.55REF		
L1	0.012	0.020	0.30	0.50	
theta	0°	8°	0°	8°	

## ■SOT-23 Suggested Pad Layout

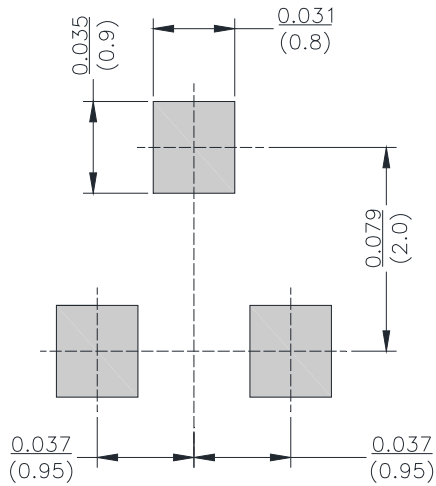

Unit:  $\frac{\text{inch}}{\text{mm}}$



## BAV23AQ/CQ/SQ

---

### Disclaimer

The information presented in this document is for reference only. Yangzhou Yangjie Electronic Technology Co., Ltd. reserves the right to make changes without notice for the specification of the products displayed herein to improve reliability, function or design or otherwise.

The product listed herein is designed to be used with automotive electronics, are not designed for use in medical, life-saving, lifesustaining, or military, Yangjie or anyone on its behalf, assumes no responsibility or liability for any damages resulting from such improper use of sale.

This publication supersedes & replaces all information previously supplied. For additional information, please visit our website [http:// www.21yangjie.com](http://www.21yangjie.com) , or consult your nearest Yangjie's sales office for further assistance.