

Non Insulated Fork Terminals

Electrolytic Copper
Soldered Barrel
Tin Plated

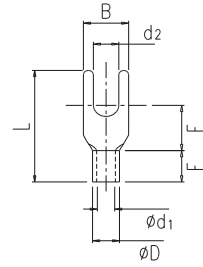

Part No	d ₂	B	L	F	E	ød ₁	øD	Wire Size AWG(mm ²)	Current Rating	Qty/Box	Weight/Box
KTL-004-01	3.2	5.7	16.0	6.5						5000	2.7 kg
KTL-004-02	3.7	5.7	16.0	6.5						5000	2.6 kg
KTL-004-03	3.7	6.2	16.0	6.5	4.5	1.7	3.4	22-16 (0.25-1.65)	19 A	5000	2.7 kg
KTL-004-04	4.3	6.4	16.0	6.5						6000	3.0 kg
KTL-004-05	4.3	7.2	16.0	6.5						6000	3.1 kg
KTL-004-06	5.3	8.0	16.0	6.5						6000	3.0 kg
KTL-004-07	3.2	5.7	16.0	6.5						5000	3.4 kg
KTL-004-08	3.7	5.7	16.0	6.5						5000	3.2 kg
KTL-004-09	3.7	6.2	16.0	6.5						5000	3.1 kg
KTL-004-10	4.3	6.4	16.0	6.5	4.5	2.3	4.0	16-14 (1.04-2.63)	27 A	5000	3.2 kg
KTL-004-11	4.3	7.2	16.0	6.5						5000	3.3 kg
KTL-004-12	5.3	8.0	16.0	6.5						5000	3.2 kg
KTL-004-13	6.4	10.7	19.0	9.0						3000	2.7 kg
KTL-004-14	4.3	8.0	18.0	6.9	6.3	3.0	5.0	12-10 (2.63-4.6)	37 A	4000	4.1 kg
KTL-004-15	5.3	8.0	18.0	8.0						4000	4.1 kg
KTL-004-16	3.2	7.3	19.5	7.1						3000	4.4 kg
KTL-004-17	3.7	8.2	19.5	7.5						3000	4.1 kg
KTL-004-18	4.3	8.2	19.5	7.5	6.5	6.5	5.6	12-10 (2.63-6.64)	48 A	3000	4.3 kg
KTL-004-19	5.3	9.0	19.5	8.0						2000	2.9 kg
KTL-004-20	6.4	12.0	25.5	12.0						2000	4.1 kg
KTL-004-21	6.7	12.0	24.0	8.5	8.6	4.5	6.9	8 (6.64-10.52)	62 A	1600	3.7 kg
KTL-004-22	5.3	12.0	27.5	11.0				6		1000	4.7 kg
KTL-004-23	6.7	12.0	27.5	11.0	10.0	5.8	8.8	(10.52-16.78)	88 A	1000	4.7 kg
KTL-004-24	8.4	14.0	34.0	13.0	12.0	12.0	11.3	4 (16.78-26.66)	115 A	400	3.5 kg

Unit = mm